

FAML 2H LHD (Long Boom)

总部地址：山东省青岛市市南区燕儿岛路10号凯悦中心办公楼3803室 邮编：266071

Office Add: Room 3803, Capland Center, No.10, Yan'erdao Road, Qingdao, Shandong province, China. P.C.:266071

电话/Tel:+86(532)87900000 传真/Fax:+86(532)85777358

工厂地址：山东青岛市城阳区烟青路（正阳路南） 邮编：266109

Factory Add: Yanqing Road, Chengyang District, Qingdao, Shandong province, China. P.C.:266109

电话/Tel:+86(532)85784255 传真/Fax:+86(532)85784541

http://www.fambition.com mail:info@fambition.com

FEATURES

SAFE WORKING ENVIRONMENT

- ISO Quality certified
- Spring applied, hydraulically release(POSI-STOP)

ENVIRONMENTAL

- Fuel efficient, clean burning Tier 2
- Platinum catalytic dry purifier and silencer

SERVICE ABILITY

- All daily check points easily reachable
- Quick and easy service to increase productivity
- Air, hydraulic and transmission filter change indicators
- Easy access to all lubrication points, filters and valve blocks.

OPERATOR'S COMFORT

- Comfortable T-Back adjustable seat
- (Hydraulic Pilot) Stick steering and dump, lift controls, ergonomically placed
- Electrically controlled gear shift
- Cabin: Ergonomically designed layout with good vision of loading face

RELIABILITY

- Proven powertrain: DANA power shift transmission
- Machine status indication lights

SPECIFICATIONS

- Vehicle height: 2170 mm
- Vehicle length: 7178 mm (tramming)
- Vehicle length: 7684 mm (level)
- Vehicle width: 1789 mm
- Ground clearance: 250 mm
- Inner turning radius: 2659 mm
- Outer turning radius: 4937 mm
- Center articulation: 40°
- Rear oscillation: 14° (one side 7°)

ENGINE

- Model: F6L914
- Power: 89 kW @ 2500 rpm
- Torque: 400 Nm @ 1500 rpm
- Fuel consumption: 220 g/kWh
- Engine protection: As per customer requests
- Air cleaner: Two stage
- Catalytic converter

TRANSMISSION / TORQUE CONVERTER

- Four speed forward and reverse
- DANA: R32425

AXLE

- Type: Rigid planetary axle for mining service

BRAKE

- Failsafe brake on all four wheels
- Type: POSI-STOP

TYRES

- Size: 12.00-24-24.SS.L-5S.TT
- Designed for underground mine services
- Pneumatic

ELECTRICAL SYSTEM

- System voltage: 24V

HYDRAULIC SYSTEM

- System pressure: 14MPa
- Pump: Gear pump / PARKER
- Flow rate: 25gpm @ 2300 rpm
- Hydraulic tank capacity: 200 L
- Hydraulic level detection

FUEL SYSTEM

Fuel tank capacity: 148 L

CAPACITIES

- Weight: 13100 kg
- Payload: 4000 kg
- Traction force: 130 kN
- Breakout force: 110 kN

SAFETY

- Boom locking pins
- Fire extinguisher

OPTIONAL EQUIPMENT

- Manually / automatically actuated fire suppression engine shut down
- Central lubrication system

DOCUMENTS

- Parts manual
- Operator Instruction
- Free Tools' List
- Free Parts' List
- Quality Certificate

总部地址：山东省青岛市市南区燕儿岛路10号凯悦中心办公楼3803室 邮编：266071

Office Add: Room 3803, Capland Center, No.10, Yan'erdao Road, Qingdao, Shandong province, China. P.C.:266071

电话/Tel:+86(532)87900000 传真/Fax:+86(532)85777358

工厂地址：山东青岛市城阳区烟青路（正阳路南） 邮编：266109

Factory Add: Yanqing Road, Chengyang District, Qingdao, Shandong province, China. P.C.:266109

电话/Tel:+86(532)85784255 传真/Fax:+86(532)85784541

http://www.fambition.com mail:info@fambition.com

DIMENSION DRAWING

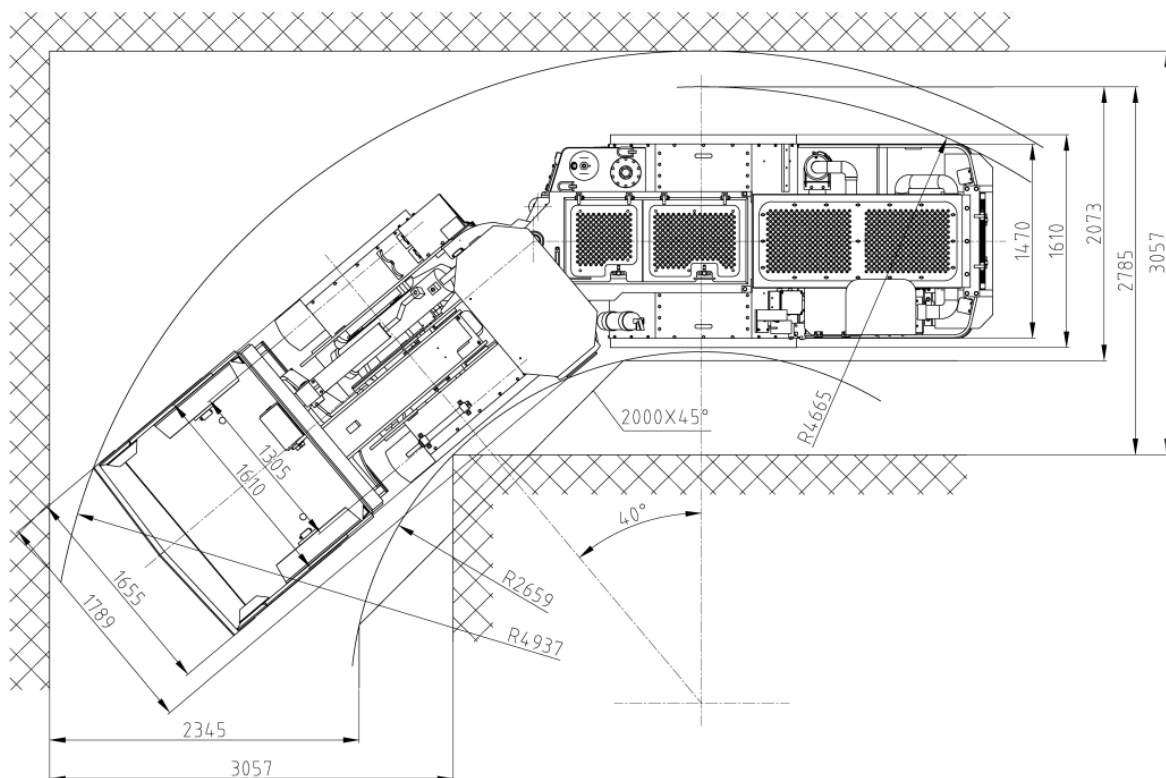
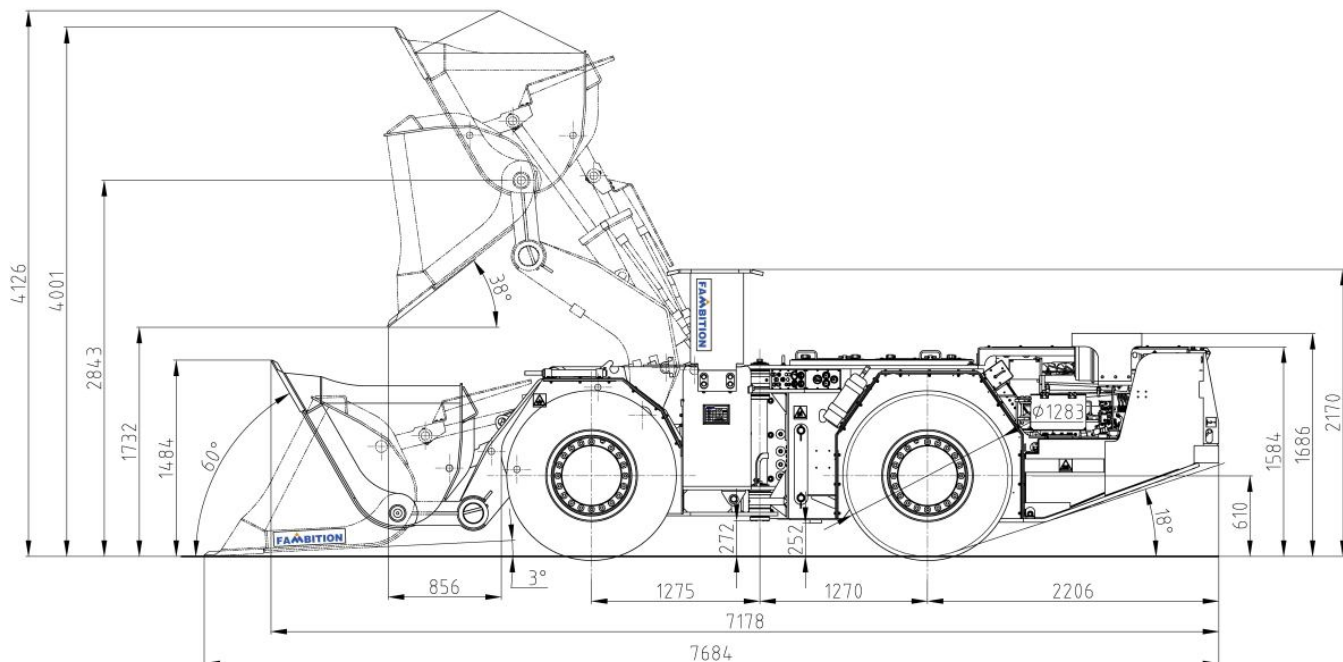

总部地址：山东省青岛市市南区燕儿岛路10号凯悦中心办公楼3803室 邮编：266071
 Office Add: Room 3803, Capland Center, No.10, Yan'erdao Road, Qingdao, Shandong province, China. P.C.:266071
电话/Tel: +86(532)87900000 传真/Fax: +86(532)85777358
工厂地址：山东青岛市城阳区烟青路（正阳路南） 邮编：266109
 Factory Add: Yanqing Road, Chengyang District, Qingdao, Shandong province, China. P.C.:266109
电话/Tel: +86(532)85784255 传真/Fax: +86(532)85784541
http://www.fambition.com mail:info@fambition.com